

INTRODUCTION

Versatile professional tripod for cameras up to medium formats. Ideal for studio and location shots.

KEY FEATURES

- Geared centre column with lock
- Anodised aluminium legs
- Telescopic mid level bracing system
- Rapid action lever leg extension locks
- Spirit level
- Rubber feet with retractable spikes
- Hanging ring for optional carrying strap

SET UP 1

Unscrew the knob "A" and open the 3 legs until part "B" (the spreader ring) makes contact with part "C" (the centre column lower stop). Lock in place by tightening the screw "A". Should you wish to achieve a smaller leg spread the spreader can be locked at a position to suit your needs, but taking account of stability requirements. On the contrary, if you wish to achieve wider leg spread you can operate on each telescopic extension "X", using as a reference the "click" stops along the sliding of the extensions.

Open the 3 extensions "X" and lock in the position by operating the knobs "K"; you can also obtain different angles of spread for each leg.

To adjust the height of the tripod, each leg has telescopic extensions that can be released by rotating lever "D" on the locking collar "E". When the required height is achieved, lock lever "D".

USE

LEVELLING 1

The tripod is supplied with a spirit level "F" to enable you to level the tripod.

FEET 1

The tripod has rubber feet "G" with retractable spikes "H" for external use.

To expose the metal spikes twist the rubber feet clockwise, to close after use twist anti clockwise. This tripod can be used with Manfrotto dollies (all have a fast action foot controlled braking system) which provide instant manoeuvrability around the studio or on location.

CENTRE COLUMN HEIGHT ADJUSTMENT 2 & 3

First release the crank handle "L", as shown in figure 2, by pressing in the ring "M" and simultaneously lifting the handle "L". Next unlock the centre column "N" (fig. 3) by unscrewing the locking knob "O". You can now adjust the height of the column by rotation of the handle "L". Once you have reached the desired height lock the column by tightening the locking knob "O".

Note: The geared centre column is safe to use even if the locking knob is not tightened; a safety ratchet lock is employed to ensure that the column will only move when cranked.

MOUNTING AND REMOVING A CAMERA HEAD 1 & 4

Remove the cap "Z" (fig. 1). Mount the camera head on the plate at the top of the sliding column via the 3/8" fixing screw. Then raise the centre column 20 cm plus and with a small screwdriver, tighten the three set screws "P" (fig. 4) up against the base of the head, taking care not to force them. This unique feature works especially well with Manfrotto heads due to the specially designed base, which prevents the head unscrewing accidentally.

To remove the head, release the set screws "P" and unscrew from the column.

TRANSPORTATION 1 2 & 5

If you want to close the spread angle of the legs very quickly in order to transport the tripod, it is not necessary to operate on each telescopic extension "X" (fig. 5); you can easily do it just releasing the locking knob "A", pulling up the part "B" until the legs fold parallel and screwing the locking knob "A".

NOTE: The spreader extensions "X" must be set up at the same length.

The tripod has an hanging ring "R" (fig. 1) for optional carrying strap.

To protect the handle "L" (fig. 1) during transportation please wind down the centre column and release the handle downward by pressing in the ring "M" (fig. 2).

LEG LOCK TENSION ADJUSTMENT 6

If the telescopic leg extensions slip even after having tightened the locking lever "D", the locking tension will need to be adjusted.

In order to do this, release lock lever "D" then turn the screw "S" clockwise using the special key "T" provided on one of the tripod legs (fig. 1).

Normally a third of a turn will be sufficient to achieve the correct locking tension.

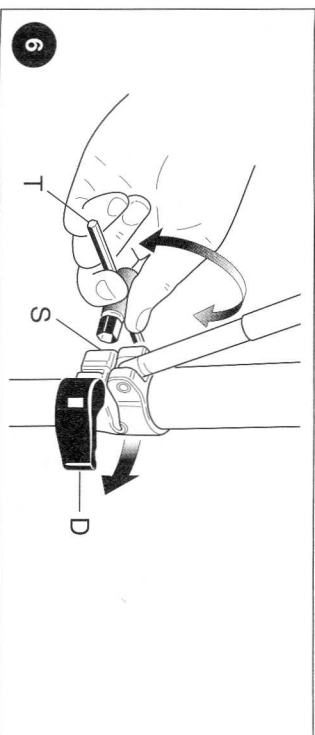
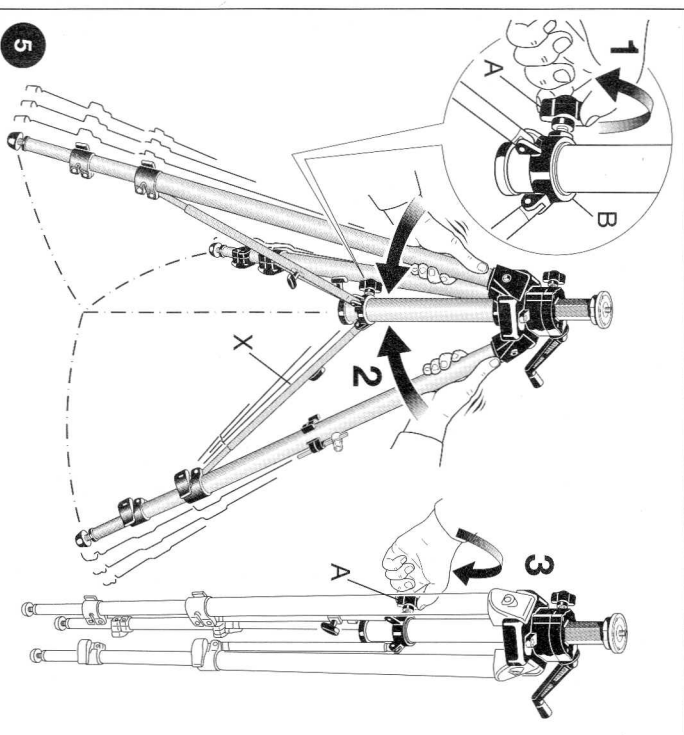
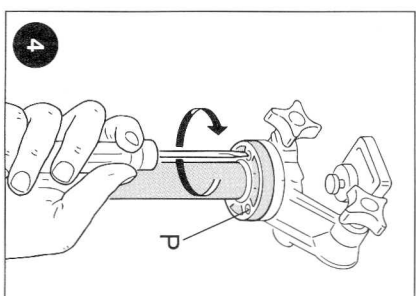
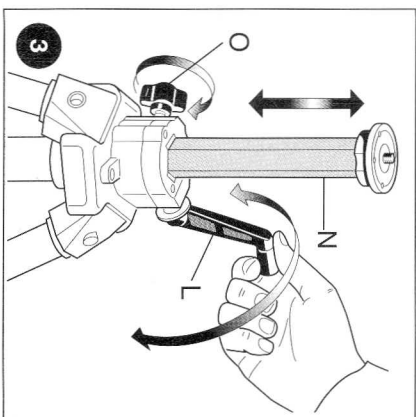
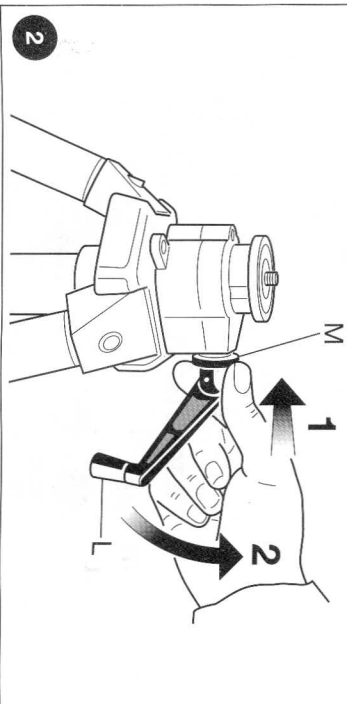
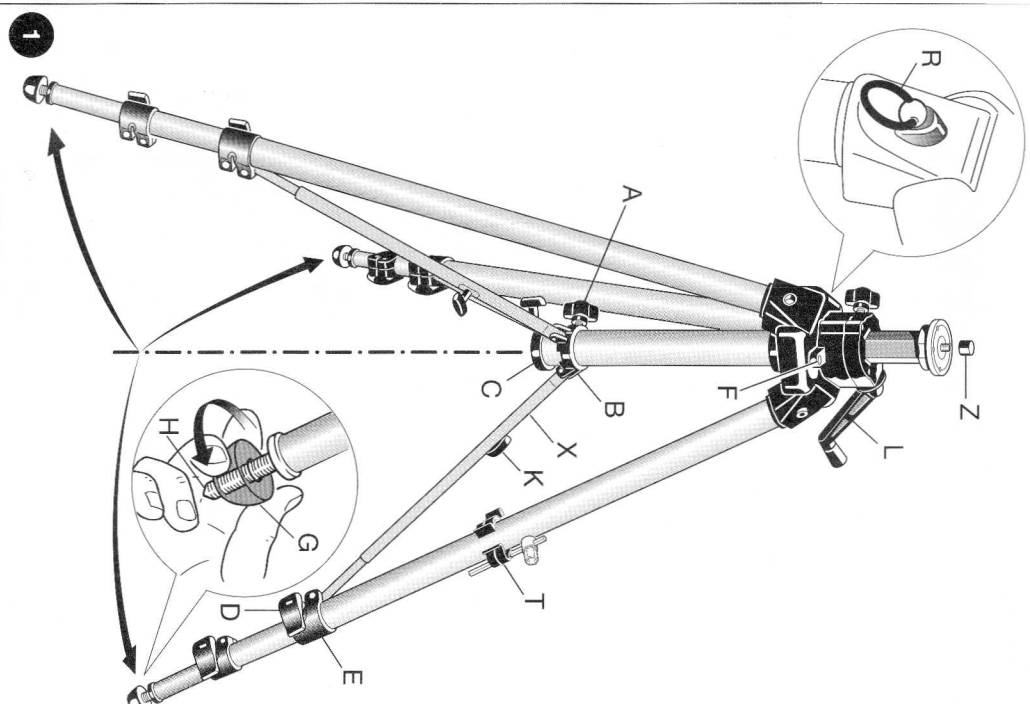

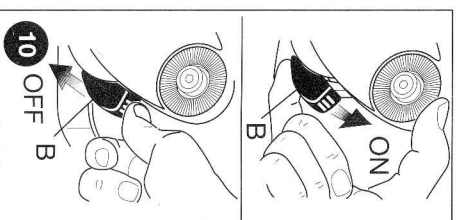
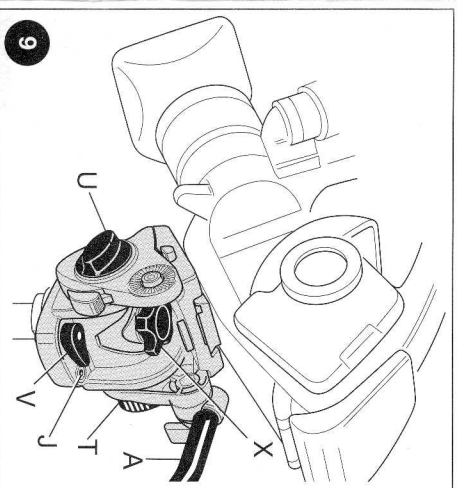
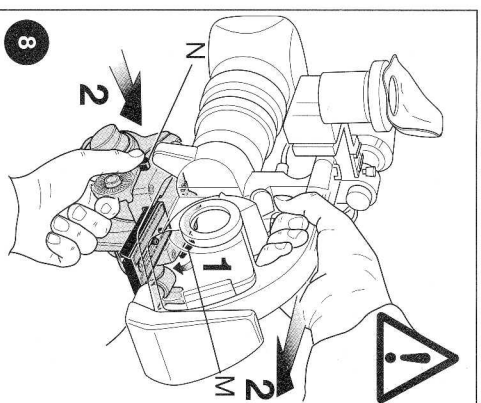
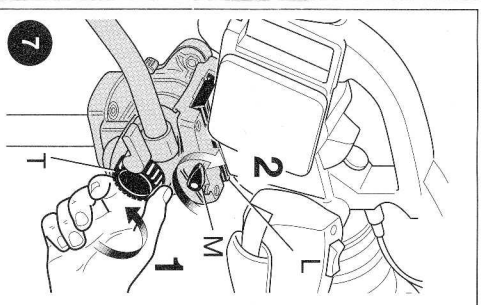
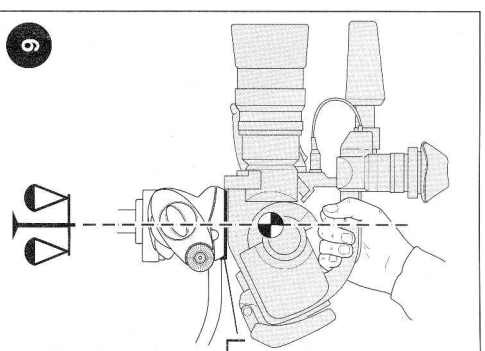
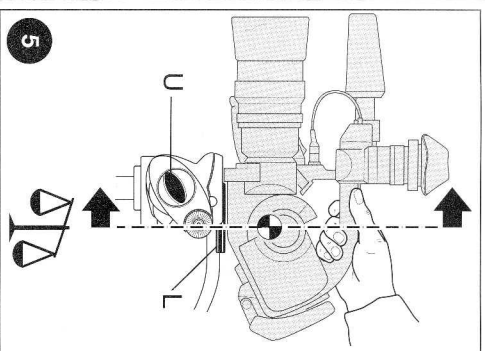
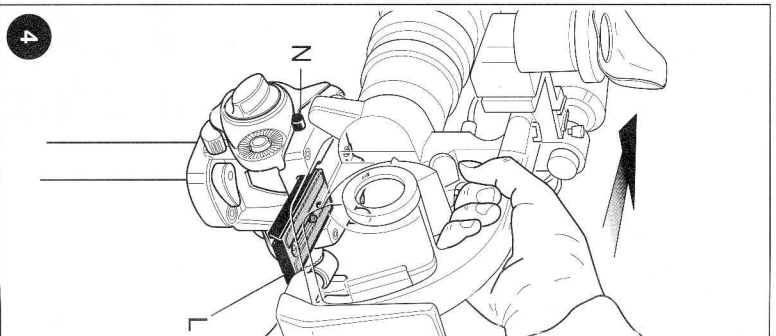
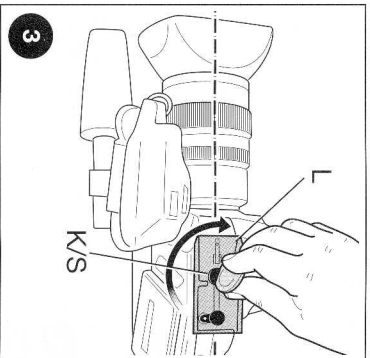
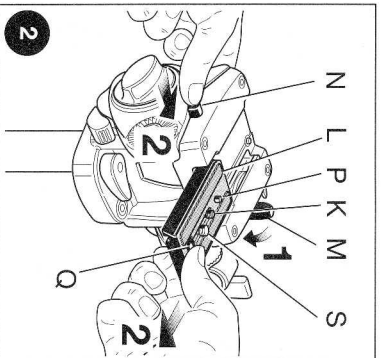
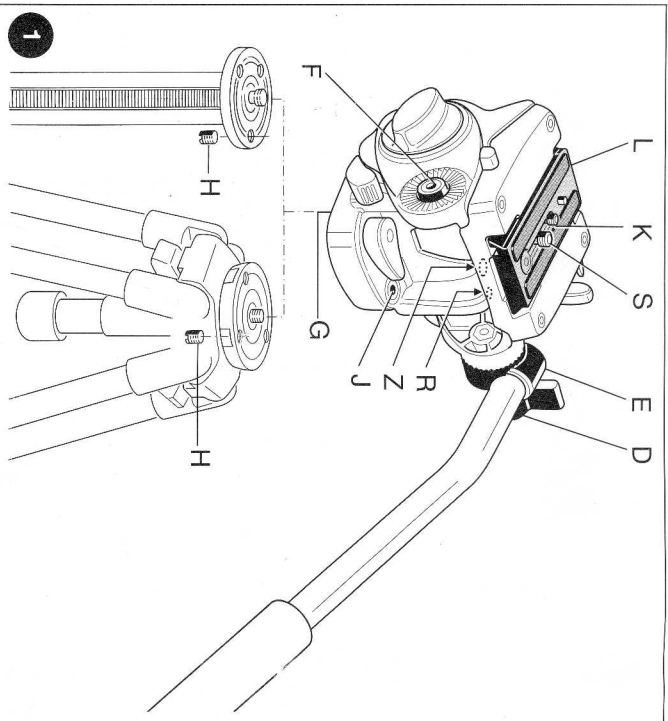

INTRODUCTION

Designed for digital ENG and DVD camcorder and the use of telescopes for loads up to 6kg.

KEY FEATURES

- Quick release sliding plate for balancing the camcorder with secondary safety latch
- 1/4" W and 3/8" W camera screw and VHS pin
- 3/8" female tripod attachment
- Additional PAN and TILT friction control
- Pan bar can be fitted left or right
- Spirit level for fine levelling
- Counter balance system for a load of approx. 2,5kg/5,5 lbs

SET UP 1

The 501HDV head is supplied with the telescopic pan bar "A" dismantled. It can be mounted to the either side of the head by unscrewing knob "D" and screwing it with the casting "E" on the hole "F".

ASSEMBLING HEAD ON TRIPOD 1

Assemble the head on the tripod using 3/8" female thread "G". The top plate on Manfrotto tripods are equipped with three set screws "H" which clamp against the base of the head to ensure effective and secure locking.

REMOVE QUICK RELEASE PLATE FROM HEAD 2

Extract plate "L" realising the locking knob "M" whilst pushing button "N" at the same time as shown in figure 2.

ASSEMBLING CAMCORDER ON PLATE 2 & 3

The head (fig. 1) is supplied with 1/4" camera screw "K" and 3/8" camera screw "S" on the plate "L".

To remove the screw not used proceed as follow (fig. 2)

- lightly press the rubber cap "Q" with your finger
- remove the screw not used
- reposition the cap to prevent the screw from being lost

NOTE

The head is provided with threaded housing for the screw not used (hole for 3/8" screw "Z" and hole for 1/4" screw "R" - fig. 1)

Fix the camcorder onto plate "L" (fig. 3) by screwing camera 1/4" screw "K" or 3/8" screw "S" into the camcorder's threaded hole WITHOUT APPLYING FORCE (using for example a coin).

If the camcorder has a hole for anti-rotation, insert the pin "P" (fig. 2) on the hole before screwing camera screw.

Before fully locking, align the camcorder lens with mark "LENS" on the camera plate "L".

MOUNTING THE CAMCORDER ON THE HEAD 1 4 5 6 & 7

Insert the camera plate "L" as shown in figure 4 on top of the head until locking button "N" clicks.

Hold the camcorder during the follow operation to prevent it from slipping backwards and forwards.

Find the balance point for the horizontally positioned camcorder.

- Level the head on the tripod (you can use both tripods with flat attachment or levelling bowl) using the spirit level "J" (fig. 1)
- With the locking knob "U" (fig. 5) unlocked and the friction control "T" (fig. 7) at minimum, slide the camcorder until find the equilibrium point (fig. 5 and 6)
- Lock the plate "L" (fig. 7) in the position reached by screwing the locking knob "W"

REMOVE THE CAMCORDER FROM THE HEAD **8**

⚠ Whenever the camcorder needs to be removed from the head, hold the camera securely in one hand while operating locking lever "M" and safety button "N" with the other hand.

USE **9** & **10**

To use the head correctly, level the head on the tripod (you can use both tripods with flat attachment or levelling bowl) using the spirit level "J" (fig. 9)

The head features 360° pan and vertical tilt (+90°/-60°) which are controlled using the pan bar "A"

- The pan movement can be locked using the knob "V" and it has an adjustable additional friction control: screwing the knob "X" the friction increases.
 - The tilt movement can be locked using the knob "U" and it has an adjustable additional friction control: screwing the knob "T" the friction increases.
 - The head is provided with a spring loaded counter balance system "B" (ON/OFF) to help to support the camera weight.
- The head can be used with or without counter balance system.

Note: The position of the locking knobs "M" (fig. 7) and "V" (fig.9) can be modified by unscrewing the screw at the edge of the knob, with a 2,5mm tool (not supplied), extracting the knob and reinserting it rotated 1/6 of turn in a more comfortable position.



Manfrotto

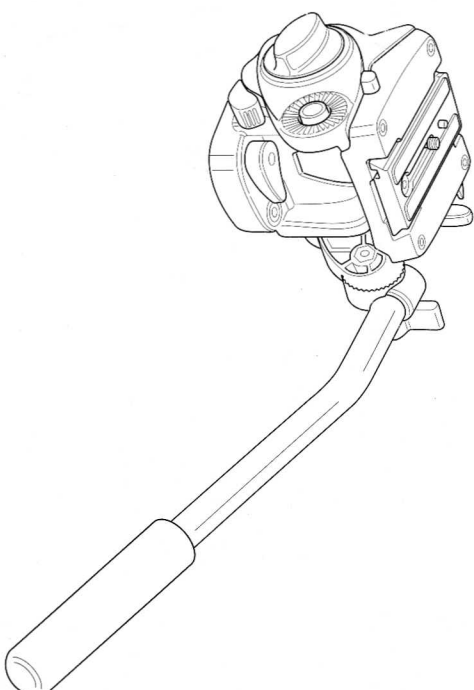

INSTRUCTIONS

501HDV



11,5 cm 1,6 kg 6 kg
4,5" 3,5 lbs 13,2 lbs